



REGO BACK CHECK VALVE

Product Code: D013

RegO Back Pressure Check Valves are designed to allow flow in one direction only. The check, normally held in the closed position by a spring, precludes the possibility of flow out of the container. When flow starts into the container, the pressure overcomes the force of the spring to open the check. When the flow stops or reverses, the check closes. Generous flow channels for low pressure drop. Heavy-duty construction for long service life. Soft seat valves have synthetic rubber seat disc for positive seals.

Applications:

- Designed to provide protection of a container opening when desired flow is always into the vessel. May be used in line applications where flow must be limited to one direction.
- When used with the appropriate single check filler valve, the combination forms a double check filler valve suitable for use in filling of bulk storage tanks.

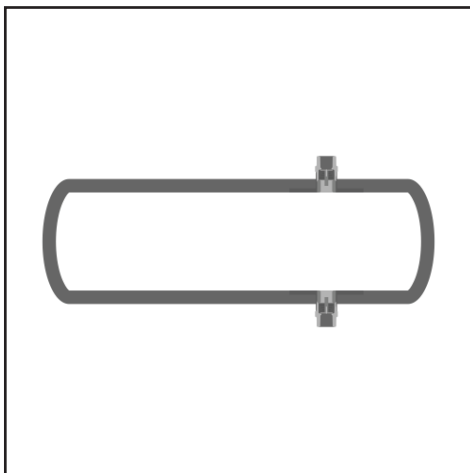

Technical Specifications:



Part Number	A Inlet Connection F. NPT	B Outlet Connection M. NPT	C Wrench Hex Flats	D Effective Length (approx.)	Propane Liquid Capacity at various differential pressures (GPM)			
					5 PSIG	10 PSIG	25 PSIG	50 PSIG
3176	1 1/4"	1 1/4"	2"	1 13/32"	28	40	63	89
				2 1/8"	32	45	73	103

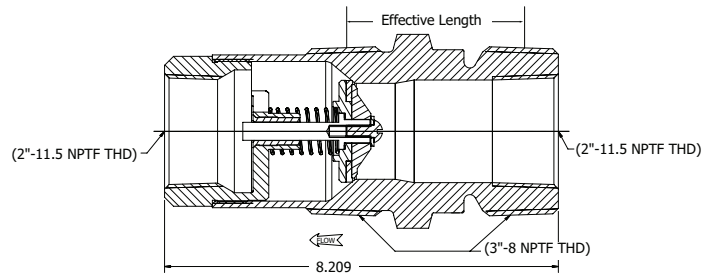

Typical Installation

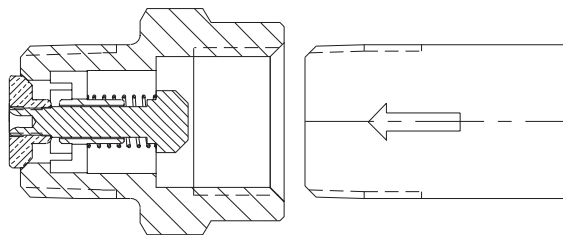

Size:

Packaging: